

Blend Jobs - Agvance Ops

Last Modified on 03/28/2025 12:05 pm CDT

To switch between Blend Jobs and Delivery Jobs, select the down arrow at the top of the screen. The number displayed indicates the number of each job type assigned to the applicator.

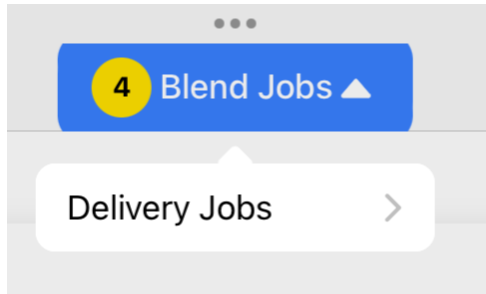

Blend Jobs

Swiping a job from right to left gives the ability to **Delete** or allows the primary Applicator to reassign the job to a secondary Applicator. The job must have at least one secondary assigned for this functionality to be visible. If multiple secondaries are assigned, a list of those are provided for the user to select one. Choosing **Delete** removes the job from the Applicator's device.

Select a job for more details and options related to that specific job. Tap **Directions** to get directions to a Meeting Point set on the map or to the job's location.

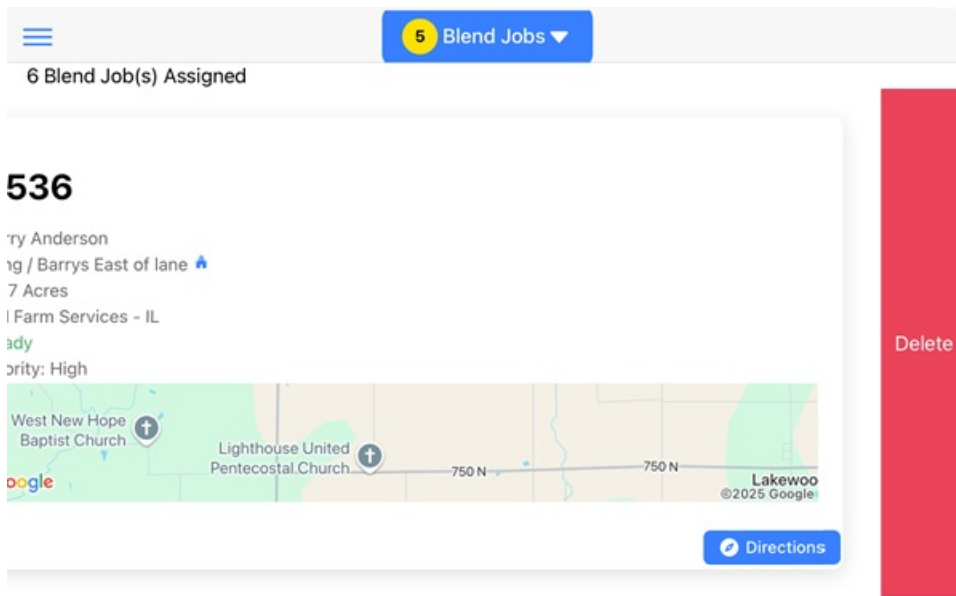

Overview

The *Overview* tab displays basic information for the Blend Ticket including *Customer Name*, *Field Description*, *Crop*, *Contacts*, *Salesperson*, *Comments*, and a map image of the Field Location.

Tap the vertical **Ellipsis** to **Refresh** or **Download Custom App Sheet**.

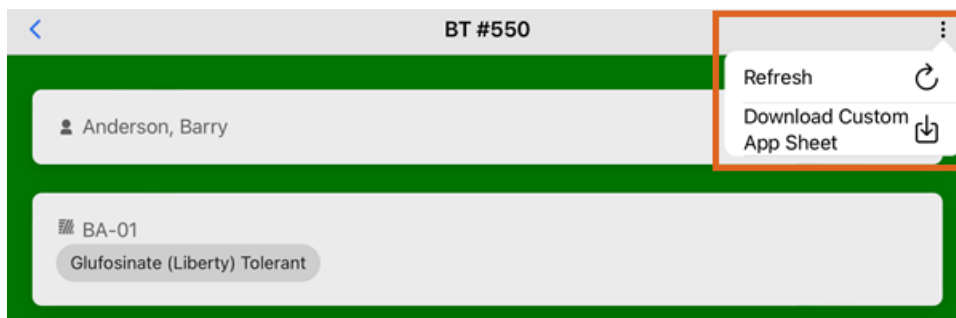

Global Layers from SKY Mapping display on the map.

Swipe the top half of the screen from left to right for more details regarding the selected Blend Ticket.



Map

On the lower half of the screen, a map of the job displays. The number of acres can be adjusted if necessary.

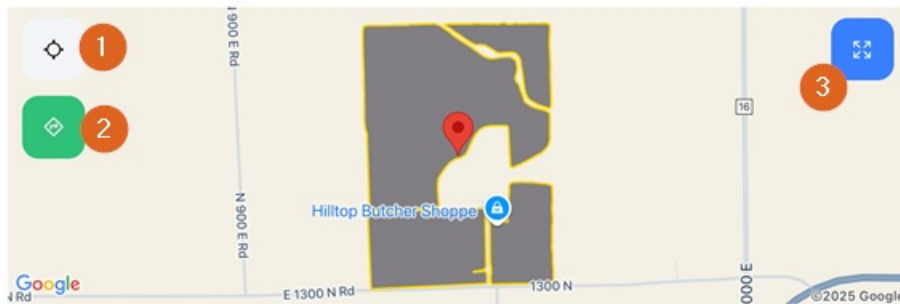

Acres Applied

97.98

Start Job

Complete Job

1. Choose the **Compass** icon for the map to zoom to the current location.
2. The **Directions** icon opens an independent map with directions to the Field Location or Meeting Point.
3. Select the **Full View Map** icon to open a full view of the satellite map.

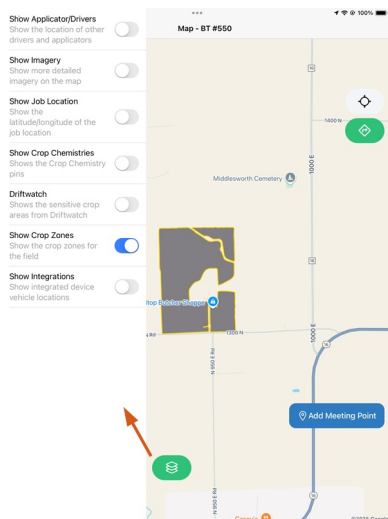

- The **Compass** and **Directions** icons are available here as well.
- Use **+ Add Meeting Point** to drop a pin indicating where tender drivers should meet for refills. Only one Meeting Point can exist on a job. Any Applicator assigned to the job can move or delete the Meeting Point by selecting **+ Edit Meeting Point**.
- The **Layers** icon opens options on the left side of the screen to indicate what should and should not be shown on the map.

Start/Complete Job

Tapping **Start Job** updates the status of the job to *In Process*. A message displays to confirm the job should be started with the option to **Start Job** or **Start Job and Capture Conditions**. Capturing conditions will pull weather data from nearby weather stations but can be revised later.

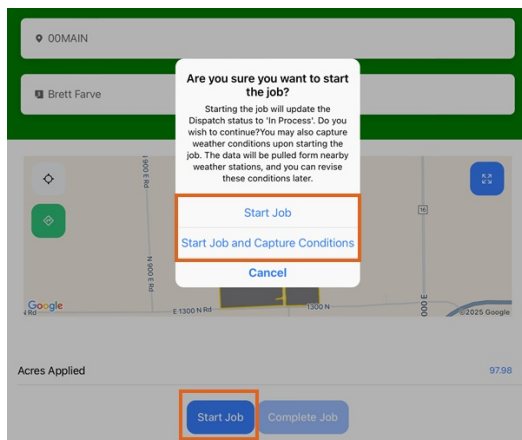

Tap **Postpone Job** to put the job *On Hold* and come back to it at a later time. Once finished, tap **Complete Job**. This will give the option to **Review Conditions** or **Capture and Review Conditions**. For applicators with *Require Conditions* turned on in SKY Dispatch, entering conditions will be required before completing the job.

Selecting **Capture and Review Conditions** will pull weather data from nearby weather stations that can be revised and will navigate to the Conditions screen to review and edit as necessary. Once all Conditions have been entered, tap **Finalize Conditions**. That job will then be removed from the jobs list and will show as *Completed* in SKY

Dispatch.

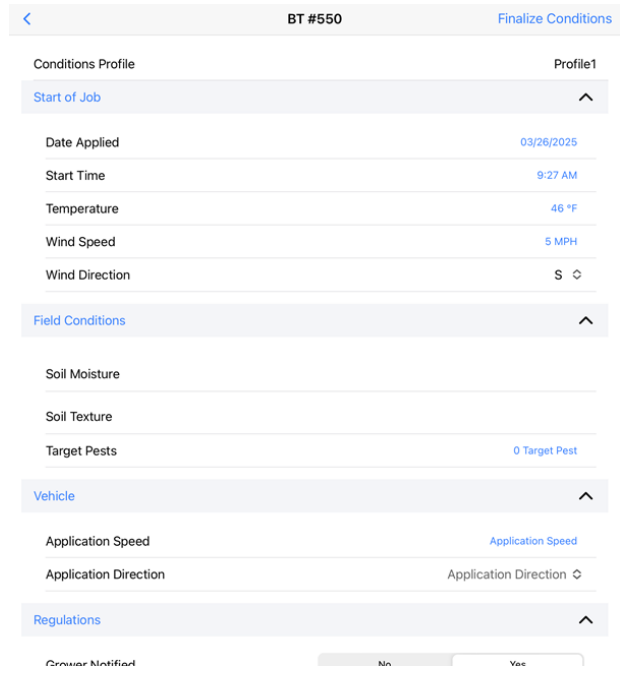
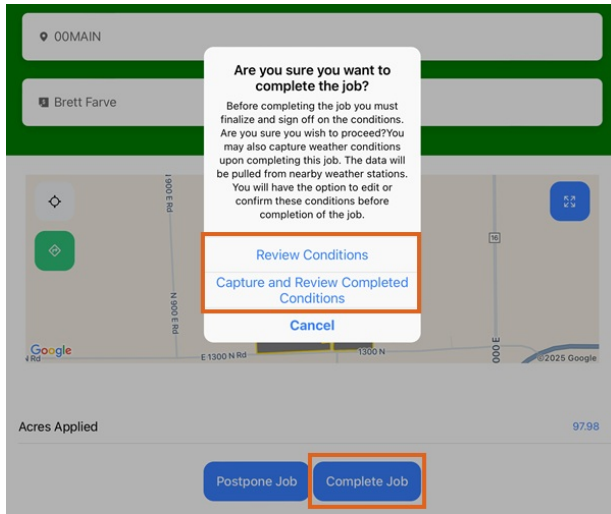

Products

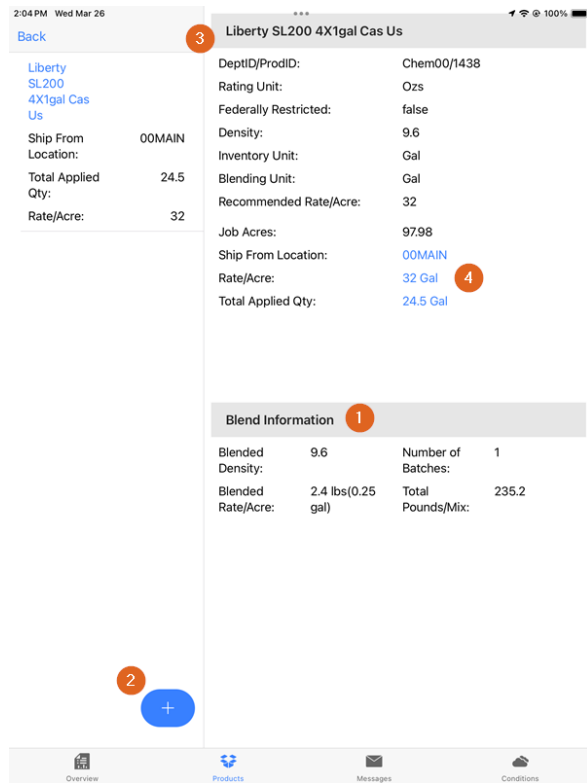

1. Blend Information for the job is available for review.
2. Search for and select additional Products by tapping the blue + icon.

3. Select the Product to view additional details.
4. The *Ship From Location*, *Rate/Acre*, and *Total Applied Qty* can all be edited here.

Messages

Choose a Dispatcher and enter the message. Selecting the **Paper Clip** icon gives the ability to add an attachment and displays a prompt to select a file or image from Storage or Photos. Tap the **Arrow** to send.

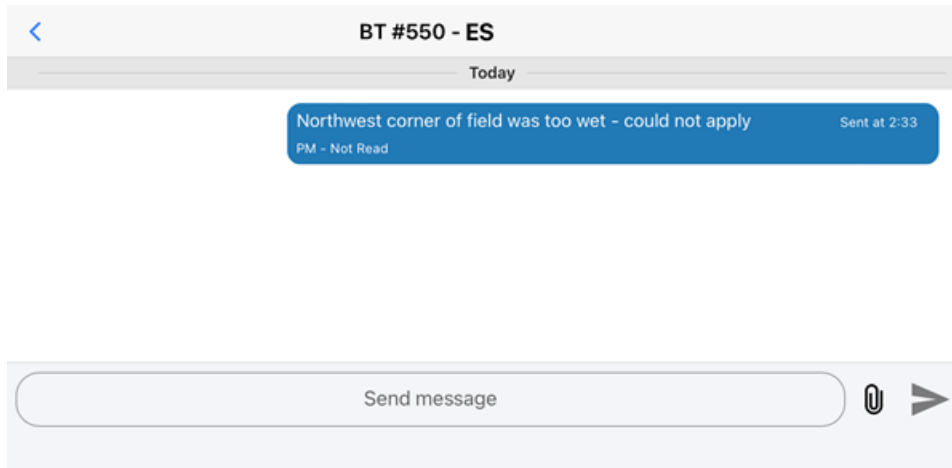

Conditions

Record or view current *Conditions* at the time of application. Any text displaying in blue indicates that information can be edited. More information on choosing and requiring conditions can be found [here](#).

Conditions include:

- *Start of Job*
- *Field Conditions*
- *Vehicle*
- *Regulations*
- *End of Job*



BT #550

Conditions Profile

Profile1

Start of Job



Date Applied

03/26/2025

Start Time

2:17 PM

Temperature

Temperature

Wind Speed

Wind Speed

Wind Direction

Wind Direction

Field Conditions



Soil Moisture

Soil Texture

Target Pests

0 Target Pest

Vehicle



Application Speed

Application Speed

Application Direction

Application Direction

Regulations



Grower Notified

No

Yes

24 Hour Forecast Max Temperature

Temperature

24 Hour Forecast Min Temperature

Temperature

24 Hour Forecast Precipitation Percentage

Precipitation Chance